

Training Shaft 2

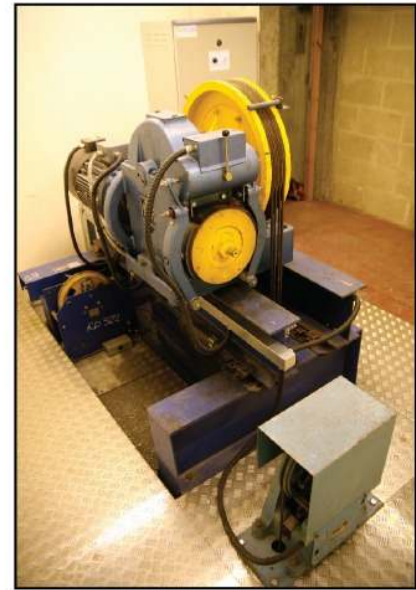
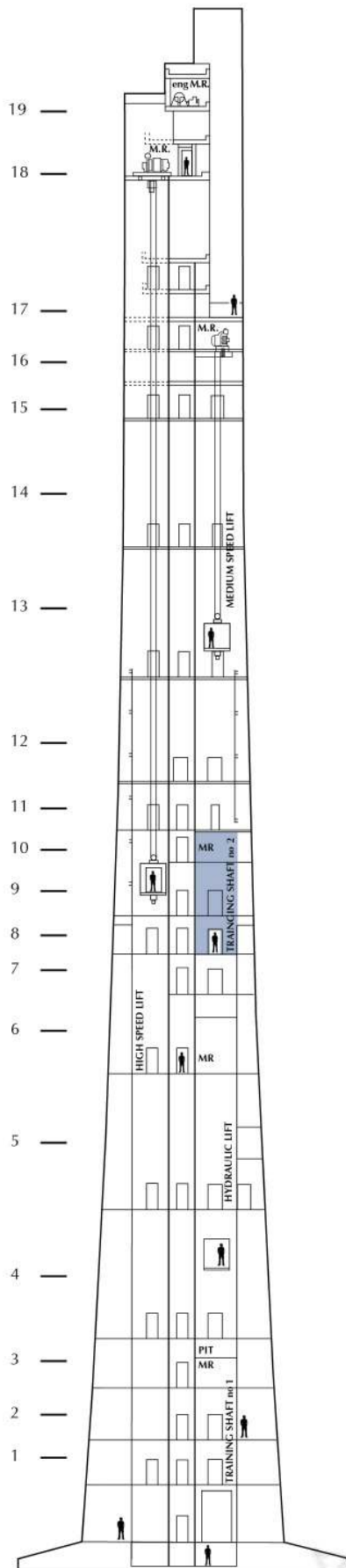

Training Shaft 2

This shaft and motor room is purposed towards providing hands on training to lift professionals. The motor room has been laid out in order to provide maximum circulation and presentation space.

Lift speed	1.6m/s
Travel	8m
Floors	Autodoors on floors 7, 8 and 9
Control system	SMS control panel with Gefran drive unit
Motor	Express motor and gearbox
Safety equipment	Express overspeed governor, OLEO buffers
Car	Express 8 person lift car and linear door operator
Rated load	630kg